

**BUILDING-STRUCTURE INVENTORY FORM**

DIVISION FOR HISTORIC PRESERVATION  
NEW YORK STATE PARKS AND RECREATION  
ALBANY, NEW YORK (518) 474-0479

FOR OFFICE USE ONLY  
UNIQUE SITE NO. 103-05-0431-D29  
QUAD \_\_\_\_\_  
SERIES \_\_\_\_\_  
NEG. NO. \_\_\_\_\_

BA 33



YOUR NAME: Town of Islip DATE: Sept. 10, 1979  
Town Hall

YOUR ADDRESS: 655 Main St., Islip TELEPHONE: 516 224-5450

ORGANIZATION (if any): Dept. of Planning and Development

\*\*\*\*\*

**IDENTIFICATION**

- 1. BUILDING NAME(S): Urban house
- 2. COUNTY: Suffolk TOWN/CITY: Islip VILLAGE: Bayport
- 3. STREET LOCATION: 572 Middle Rd., south side, opp. Bayport Ave.
- 4. OWNERSHIP: a. public  b. private
- 5. PRESENT OWNER: Urban ADDRESS: 572 Middle Rd., Bayport
- 6. USE: Original: residence Present: residence
- 7. ACCESSIBILITY TO PUBLIC: Exterior visible from public road: Yes  No   
Interior accessible: Explain by appointment

**DESCRIPTION**

- 8. BUILDING MATERIAL: a. clapboard  b. stone  c. brick  d. board and batten   
e. cobblestone  f. shingles  g. stucco  other: \_\_\_\_\_
- 9. STRUCTURAL SYSTEM: a. wood frame with interlocking joints   
(if known) b. wood frame with light members   
c. masonry load bearing walls   
d. metal (explain) \_\_\_\_\_  
e. other \_\_\_\_\_
- 10. CONDITION: a. excellent  b. good  c. fair  d. deteriorated
- 11. INTEGRITY: a. original site  b. moved  if so, when? \_\_\_\_\_  
c. list major alterations and dates (if known): \_\_\_\_\_

12. PHOTO: ELW II, # 8A  
from NW, front

13. MAP: Bowe, Albertson Sewer Maps, Bayport Q 1

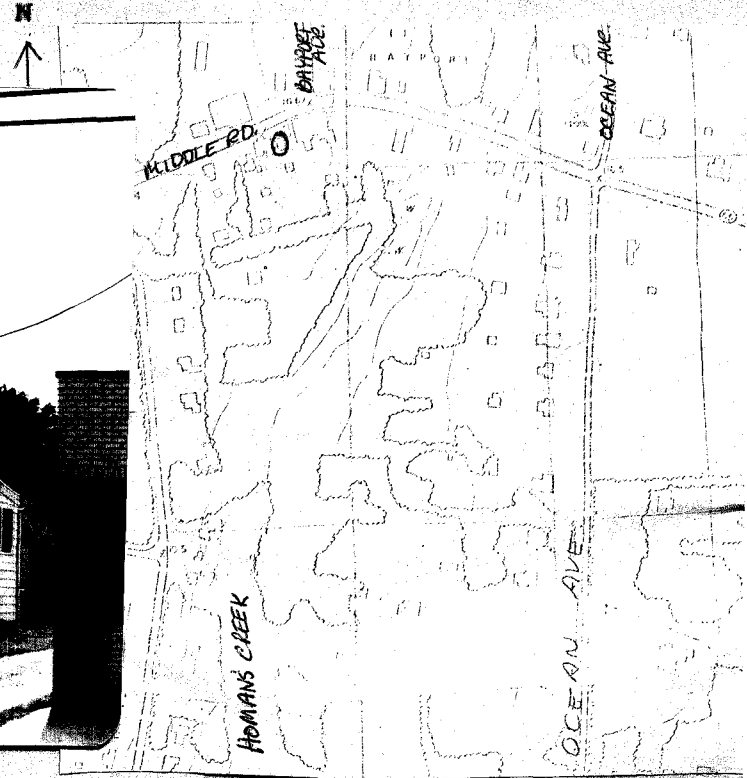
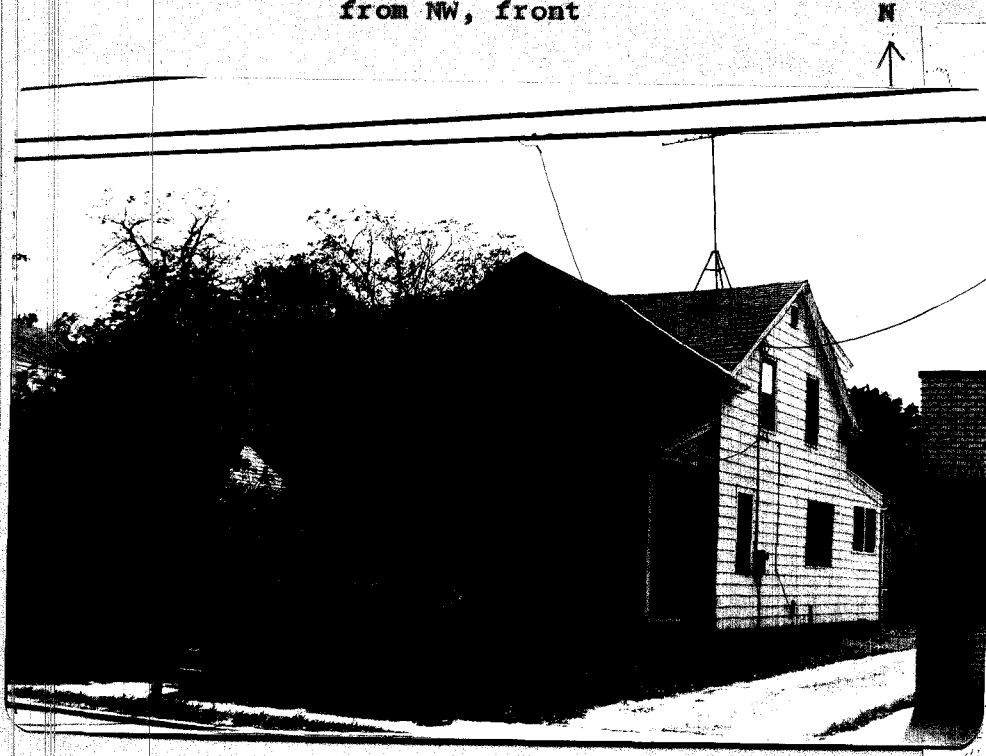

14. THREATS TO BUILDING: a. none known  b. zoning  c. roads   
 d. developers  e. deterioration   
 f. other: \_\_\_\_\_
15. RELATED OUTBUILDINGS AND PROPERTY:  
 a. barn  b. carriage house  c. garage   
 d. privy  e. shed  f. greenhouse   
 g. shop  h. gardens   
 i. landscape features: \_\_\_\_\_  
 j. other: \_\_\_\_\_
16. SURROUNDINGS OF THE BUILDING (check more than one if necessary):  
 a. open land  b. woodland   
 c. scattered buildings   
 d. densely built-up  e. commercial   
 f. industrial  g. residential   
 h. other: \_\_\_\_\_

17. INTERRELATIONSHIP OF BUILDING AND SURROUNDINGS:  
 (Indicate if building or structure is in an historic district)

**This house is located in Middle Road (Main St.) Bayport, where many of the houses date back over one hundred years.**

18. OTHER NOTABLE FEATURES OF BUILDING AND SITE (including interior features if known):

**SIGNIFICANCE**

19. DATE OF INITIAL CONSTRUCTION: before 1873\*

ARCHITECT: \_\_\_\_\_

BUILDER: \_\_\_\_\_

20. HISTORICAL AND ARCHITECTURAL IMPORTANCE:

**One and one-half story, gable roof house with original porch with sawn spandrels. Side entrance with pilasters. This house is identified on the 1873 Atlas as that of Chas. Everitt. In 1915, it belonged to C. Everitts.**

21. SOURCES: **\*Beers, F.W., Atlas of Long Island, Brooklyn: 1873, Bayport, p. 154  
 Belcher-Hyde, E., Atlas of Suffolk County, Brooklyn: 1915, p. 32.**

22. THEME:  
**residential.**