

**BUILDING-STRUCTURE INVENTORY FORM**

FOR OFFICE USE ONLY

BO 10

DIVISION FOR HISTORIC PRESERVATION  
NEW YORK STATE PARKS AND RECREATION  
ALBANY, NEW YORK (518) 474-0479

UNIQUE SITE NO. 10305\_000800  
QUAD \_\_\_\_\_  
SERIES \_\_\_\_\_  
NEG. NO. \_\_\_\_\_

YOUR NAME: Town of Islip/SPLIA DATE: March 1990  
Town Hall, 655 Main St.  
YOUR ADDRESS: Islip, L.I., N.Y. 11751 TELEPHONE: 516.224.5450  
ORGANIZATION (if any): Dept. of Planning, Housing, and Development

**IDENTIFICATION**

1. BUILDING NAME(S): Stockel House  
2. COUNTY: Suffolk TOWN/CITY: Islip VILLAGE: Bohemia  
3. STREET LOCATION: 935 Church St.  
4. OWNERSHIP: a. public  b. private   
5. PRESENT OWNER: \_\_\_\_\_ ADDRESS: \_\_\_\_\_  
6. USE: Original: residence Present: residence  
7. ACCESSIBILITY TO PUBLIC: Exterior visible from public road: Yes  No   
Interior accessible: Explain private residence

**DESCRIPTION**

8. BUILDING MATERIAL: a. clapboard  b. stone  c. brick  d. board and batten   
e. cobblestone  f. shingles  g. stucco  other: \_\_\_\_\_  
9. STRUCTURAL SYSTEM: a. wood frame with interlocking joints   
(if known) b. wood frame with light members   
c. masonry load bearing walls   
d. metal (explain) \_\_\_\_\_  
e. other \_\_\_\_\_  
10. CONDITION: a. excellent  b. good  c. fair  d. deteriorated   
11. INTEGRITY: a. original site  b. moved  if so, when? \_\_\_\_\_  
c. list major alterations and dates (if known):  
some windows altered

12. PHOTO: Neg. KK XXIII-2, fm. SE 13. MAP: NYS DOT Patchogue Quad

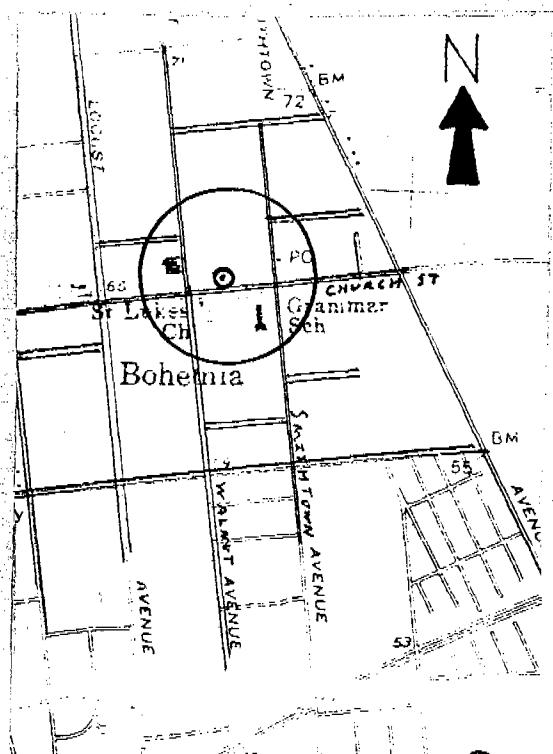

HP-1

14. THREATS TO BUILDING: a. none known  b. zoning  c. roads   
 d. developers  e. deterioration   
 f. other: \_\_\_\_\_
15. RELATED OUTBUILDINGS AND PROPERTY:  
 a. barn  b. carriage house  c. garage   
 d. privy  e. shed  f. greenhouse   
 g. shop  h. gardens   
 i. landscape features: \_\_\_\_\_  
 j. other: \_\_\_\_\_
16. SURROUNDINGS OF THE BUILDING (check more than one if necessary):  
 a. open land  b. woodland   
 c. scattered buildings   
 d. densely built-up  e. commercial   
 f. industrial  g. residential   
 h. other: cemetery directly S
17. INTERRELATIONSHIP OF BUILDING AND SURROUNDINGS:  
 (Indicate if building or structure is in an historic district)

The Stockel House is located on the north side of the street opposite the Union Cemetery (BO 9) among residences of similiar age and scale.

18. OTHER NOTABLE FEATURES OF BUILDING AND SITE (including interior features if known):

The Stockel House is a 2½ story, gable roof house with a semi-hexagonal two story bay window with gabled pediment on the west part of the main facade. The house contains a porch across the principle (south) facade with a projecting gable and squared posts on a knee-wall.

SIGNIFICANCE

19. DATE OF INITIAL CONSTRUCTION: Prior to 1915

ARCHITECT: \_\_\_\_\_

BUILDER: \_\_\_\_\_

20. HISTORICAL AND ARCHITECTURAL IMPORTANCE:

This is one of the later houses that characterizes historic Bohemia.

21. SOURCES:

E. Belcher Hyde. Atlas of the Ocean Shore of Suffolk County, L.I. (west-erly section), 1915.

22. THEME:

Research by Society for the Preservation of Long Island Antiquities - KEK