

BUILDING-STRUCTURE INVENTORY FORM

DIVISION FOR HISTORIC PRESERVATION
NEW YORK STATE PARKS AND RECREATION
ALBANY, NEW YORK (518) 474-0479

FOR OFFICE USE ONLY

BO 4

UNIQUE SITE NO. 10305 00079 4
QUAD _____
SERIES _____
NEG. NO. _____

YOUR NAME: Town of Islip/SPLIA DATE: March 1990
Town Hall, 655 Main St.
YOUR ADDRESS: Islip, L.I., N.Y. 11751 TELEPHONE: 516.224.5450
ORGANIZATION (if any): Dept. of Planning, Housing, and Development

IDENTIFICATION

1. BUILDING NAME(S): Frank Huml Store
2. COUNTY: Suffolk TOWN/CITY: Islip VILLAGE: Bohemia
3. STREET LOCATION: 1280 Smithtown Ave.
4. OWNERSHIP: a. public b. private
5. PRESENT OWNER: _____ ADDRESS: _____
6. USE: Original: store Present: residence
7. ACCESSIBILITY TO PUBLIC: Exterior visible from public road: Yes No
Interior accessible: Explain private residence

DESCRIPTION

8. BUILDING MATERIAL: a. clapboard b. stone c. brick d. board and batten
e. cobblestone f. shingles g. stucco other: modern siding
9. STRUCTURAL SYSTEM: a. wood frame with interlocking joints
(if known) b. wood frame with light members
c. masonry load bearing walls
d. metal (explain) _____
e. other _____
10. CONDITION: a. excellent b. good c. fair d. deteriorated
11. INTEGRITY: a. original site b. moved if so, when? _____
c. list major alterations and dates (if known).
principle facade covered with stucco

12. PHOTO: Neg. KK XIX-15, fm. SW

13. MAP: NYS DOT Patchogue Quad

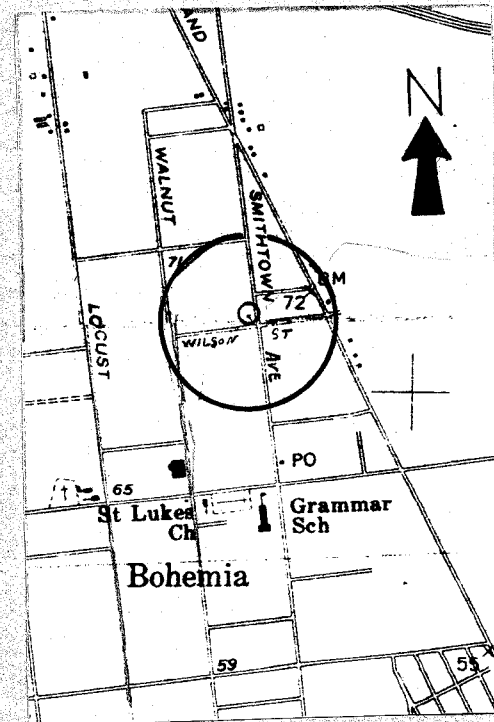

14. THREATS TO BUILDING: a. none known b. zoning c. roads
 d. developers e. deterioration
 f. other: _____
15. RELATED OUTBUILDINGS AND PROPERTY:
 a. barn b. carriage house c. garage
 d. privy e. shed f. greenhouse
 g. shop h. gardens
 i. landscape features: _____
 j. other: _____
16. SURROUNDINGS OF THE BUILDING (check more than one if necessary):
 a. open land b. woodland
 c. scattered buildings
 d. densely built-up e. commercial
 f. industrial g. residential
 h. other: _____

17. INTERRELATIONSHIP OF BUILDING AND SURROUNDINGS:
 (Indicate if building or structure is in an historic district)

1280 Smithtown Avenue is located on the west side of the street, set close to the sidewalk line in a residential area of detached buildings of similar size and scale that line this road and adjoining streets.

18. OTHER NOTABLE FEATURES OF BUILDING AND SITE (including interior features if known):
 1280 Smithtown Avenue is a small, 1½ story, gable roof, gable end to the street building with a stucco parapet roof principle (east) facade and indented center entrance bay. A small hip roof, single story wing is attached to the south.

SIGNIFICANCE

19. DATE OF INITIAL CONSTRUCTION: _____ Prior to 1915

ARCHITECT: _____

BUILDER: _____

20. HISTORICAL AND ARCHITECTURAL IMPORTANCE:

Frank Huml had a cigar factory in one of the buildings on his property (see 1915 atlas) that was destroyed by fire. This store is a fine example of an early Bohemia commercial building.

21. SOURCES:

E. Belcher Hyde. Atlas of the Ocean Shore of Suffolk County, L.I., (west-erly section), 1915.

A History of Bohemia, 1985, pp. 2 and 3.

22. THEME:

Research by Society for the Preservation of Long Island Antiquities - KEK

BOHEMIA

E. Belcher Hyde. Atlas of the Ocean Shore of Suffolk County,
 L.I. (westerly section), 1915.

