

BUILDING-STRUCTURE INVENTORY FORM

DIVISION FOR HISTORIC PRESERVATION
NEW YORK STATE PARKS AND RECREATION
ALBANY, NEW YORK (518) 474-0479

FOR OFFICE USE ONLY	
UNIQUE SITE NO. <u>103-05-0141-003</u>	C.I.#62
QUAD _____	
SERIES _____	
NEG. NO. _____	

YOUR NAME: Town of Islip DATE: September 24, 1975
Town Hall
 YOUR ADDRESS: 655 Main Street TELEPHONE: (516) 581-2000
 ORGANIZATION (if any): Department of Planning, Housing & Development

IDENTIFICATION

Central Islip State Hospital's
 1. BUILDING NAME(S): Staff Cottages A, B, And C Bldgs. 8, 9, 14
 2. COUNTY: Suffolk TOWN/CITY: Islip VILLAGE: Central Islip
 3. STREET LOCATION: West side of Carleton Avenue
 4. OWNERSHIP: a. public b. private
 5. PRESENT OWNER: _____ ADDRESS: _____
 6. USE: Original: _____ Present: Staff Cottages
 7. ACCESSIBILITY TO PUBLIC: Exterior visible from public road: Yes No
 Interior accessible: Explain By appointment only

DESCRIPTION

8. BUILDING MATERIAL: a. clapboard b. stone c. brick d. board and batten
 e. cobblestone f. shingles g. stucco other: _____
 9. STRUCTURAL SYSTEM: a. wood frame with interlocking joints
 (if known) b. wood frame with light members
 c. masonry load bearing walls
 d. metal (explain) _____
 e. other _____
 10. CONDITION: a. excellent b. good c. fair d. deteriorated
 11. INTEGRITY: a. original site b. moved if so, when? _____
 c. list major alterations and dates (if known): _____

12. PHOTO:



13. MAP:

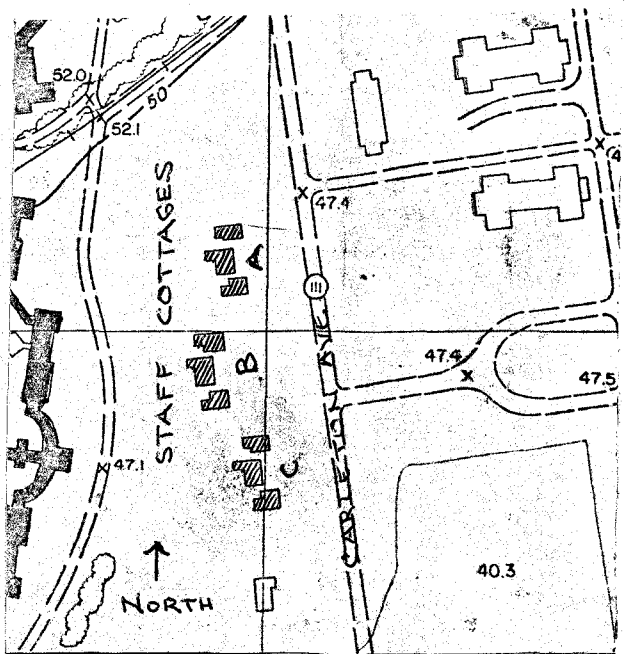

HP-1 Roll #Q7; Negative #7
 Group B - East (front) & North sides.

14. THREATS TO BUILDING: a. none known b. zoning c. roads
d. developers e. deterioration
f. other: _____
15. RELATED OUTBUILDINGS AND PROPERTY:
a. barn b. carriage house c. garage
d. privy e. shed f. greenhouse
g. shop h. gardens
i. landscape features: _____
j. other: _____
16. SURROUNDINGS OF THE BUILDING (check more than one if necessary):
a. open land b. woodland
c. scattered buildings
d. densely built-up e. commercial
f. industrial g. residential
h. other: _____

17. INTERRELATIONSHIP OF BUILDING AND SURROUNDINGS:
(Indicate if building or structure is in an historic district)

Central Islip State Hospital is located on a 1000 acre wooded property, running from Clayton St. to Southern State Parkway, on both sides of Carleton Ave. The grounds contain buildings from various periods and in various architectural styles. These English Manor style buildings face Carleton Avenue, as do other staff buildings.

18. OTHER NOTABLE FEATURES OF BUILDING AND SITE (including interior features if known):

Each group consists of three attached buildings - a center unit and two flanking wings with one story connections. The main structures are two and one-half stories with slate gabled roofs.

SIGNIFICANCE

19. DATE OF INITIAL CONSTRUCTION: unknown 1930

ARCHITECT: unknown DPW, Wm E. Hanguant, Comm. of Arch.

BUILDER: unknown

20. HISTORICAL AND ARCHITECTURAL IMPORTANCE:

These three groups of staff cottages are in the English Manor Style; each consists of three connected units. The center section's front entrance projects forward, has a low hip roof, brackets, and a front door with decorative panelling and glass. The wings have entrances with triangular-bracketed slate roofed hoods. The doors on the northern one-story connections have gabled entries with decorative perforations and triangular brackets. There are original six-over-six windows and bay windows. There are gabled dormers facing the interior of the units, and shed-roof dormers facing the exterior. The chimneys are wide and projecting.

21. SOURCES:

Bellsmith, Ethel. History of Central Islip State Hospital: 1887-1946.
(Unpublished material by Supervisor of Social Work)

22. THEME:

Research by the Society for the Preservation of Long Island Antiquities.
(Judith Saltzman)