

BUILDING-STRUCTURE INVENTORY FORM

DIVISION FOR HISTORIC PRESERVATION
NEW YORK STATE PARKS AND RECREATION
ALBANY, NEW YORK (518) 474-0479

FOR OFFICE USE ONLY
UNIQUE SITE NO. 103-05-0249
QUAD _____
SERIES _____
NEG. NO. _____

II-2

JUN 21 1977

YOUR NAME: Town of Islip DATE: 2 September 1976
Town Hall
YOUR ADDRESS: 655 Main Street TELEPHONE: 516 581-2000
Islip, L.I., N.Y. 11751
ORGANIZATION (if any): Department of Planning, Housing & Development

IDENTIFICATION

- 1. BUILDING NAME(S): William Hrubes Residence
- 2. COUNTY: Suffolk TOWN/CITY: Islip VILLAGE: East Islip
- 3. STREET LOCATION: 151 West Main St., East Islip, North side
- 4. OWNERSHIP: a. public b. private
- 5. PRESENT OWNER: W. Hrubes ADDRESS: Above
- 6. USE: Original: Residence Present: Residence
- 7. ACCESSIBILITY TO PUBLIC: Exterior visible from public road: Yes No
Interior accessible: Explain _____

DESCRIPTION

- 8. BUILDING MATERIAL: a. clapboard b. stone c. brick d. board and batten
e. cobblestone f. shingles g. stucco other: _____
- 9. STRUCTURAL SYSTEM: a. wood frame with interlocking joints
(if known) b. wood frame with light members
c. masonry load bearing walls
d. metal (explain) _____
e. other _____
- 10. CONDITION: a. excellent b. good c. fair d. deteriorated
- 11. INTEGRITY: a. original site b. moved if so, when? _____
c. list major alterations and dates (if known): _____

ROLL ISL-BAN-II-2
NEGATIVE II-3
12. PHOTO: LOOKING NORTH

13. MAP: sewer map Q 11

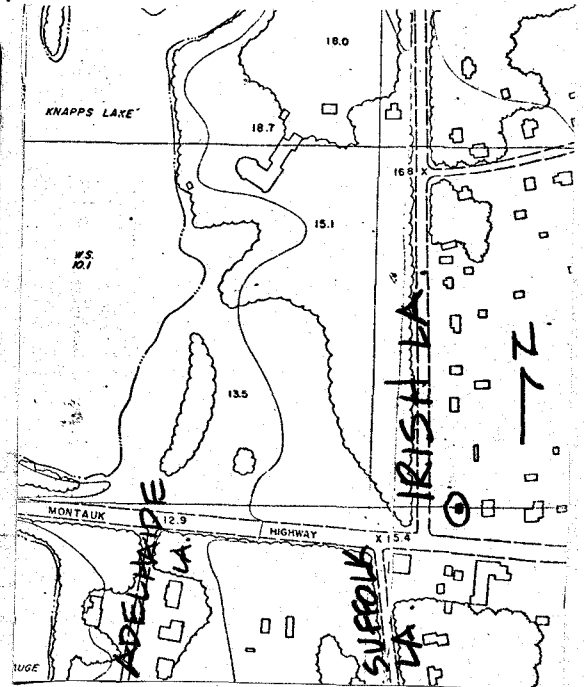

NEGATIVES DEPOSITED AT
SOCIETY FOR PRESERVATION OF
L. I. ANTIQUITIES

14. THREATS TO BUILDING: a. none known b. zoning c. roads
d. developers e. deterioration
f. other: _____

15. RELATED OUTBUILDINGS AND PROPERTY:
a. barn b. carriage house c. garage
d. privy e. shed f. greenhouse
g. shop h. gardens
i. landscape features: _____
j. other: _____

16. SURROUNDINGS OF THE BUILDING (check more than one if necessary):
a. open land b. woodland
c. scattered buildings
d. densely built-up e. commercial
f. industrial g. residential
h. other: _____

17. INTERRELATIONSHIP OF BUILDING AND SURROUNDINGS:
(Indicate if building or structure is in an historic district)

18. OTHER NOTABLE FEATURES OF BUILDING AND SITE (including interior features if known):
Corbelled brick chimney; balcon fenetres; original clapboards.

* 4/4 WINDOWS

SIGNIFICANCE

19. DATE OF INITIAL CONSTRUCTION: Before 1873

ARCHITECT: _____

BUILDER: _____

20. HISTORICAL AND ARCHITECTURAL IMPORTANCE:

1873 map: T. Smith
1915 map: 2 story house owned by T. Smith Estate

21. SOURCES:

Beers, S. W. Atlas of Long Island, N. Y. New York: Beers, Comstock & Cline, 1873. p.151.
Hyde, E. Belcher. Atlas of the Ocean Shore of Suffolk County, L.I.
22. THEME: Westerly Section, Brooklyn-Manhattan, 1915. plate 25.

Research by: Society for the Preservation of Long Island Antiquities
Barbara Nadel, Research Assistant

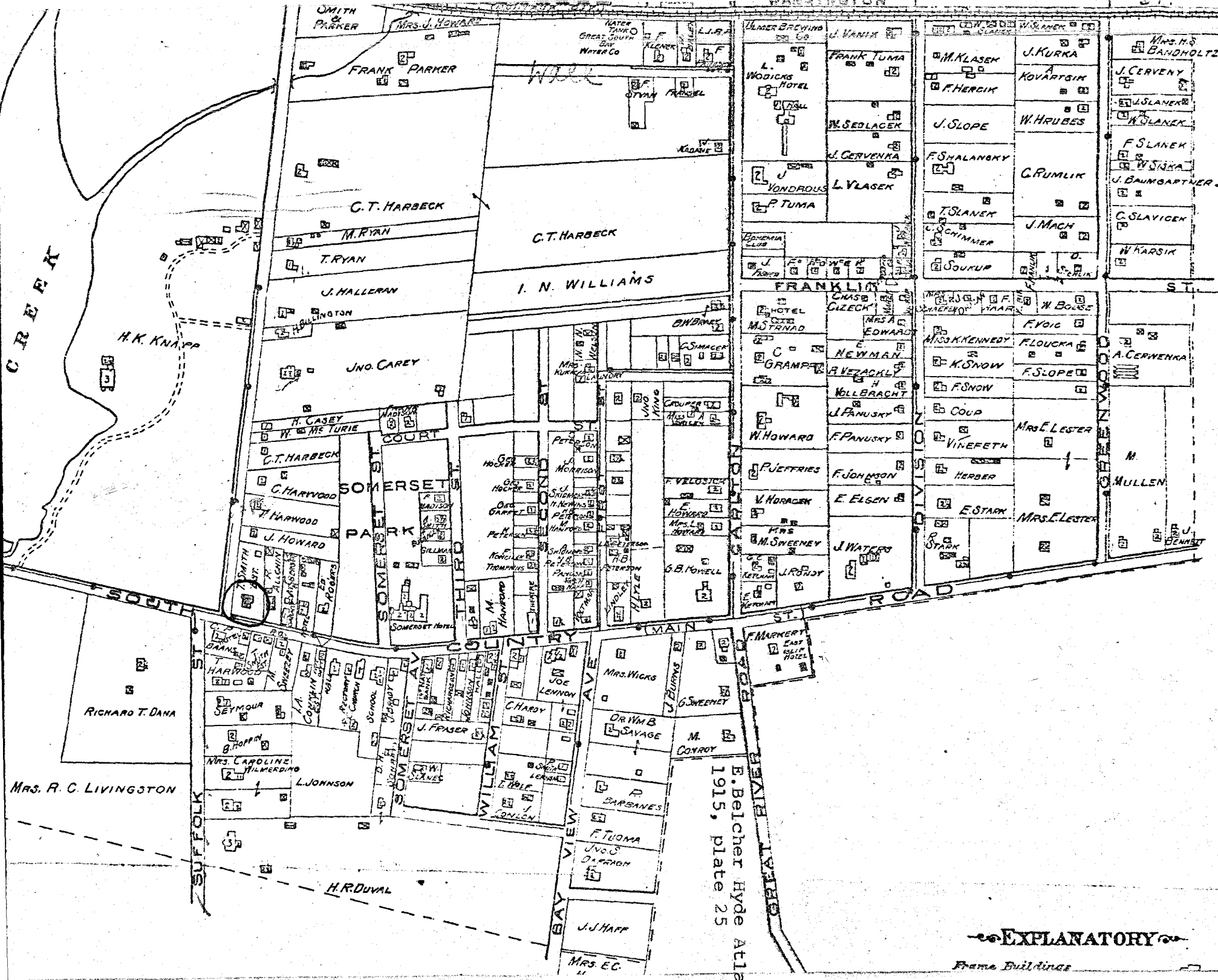

E. Belcher Hyde Atlas
1915, plate 25

II-2

EXPLANATORY
Frame Buildings

ISLIP

TOWN OF ISLIP
SUFFOLK CO

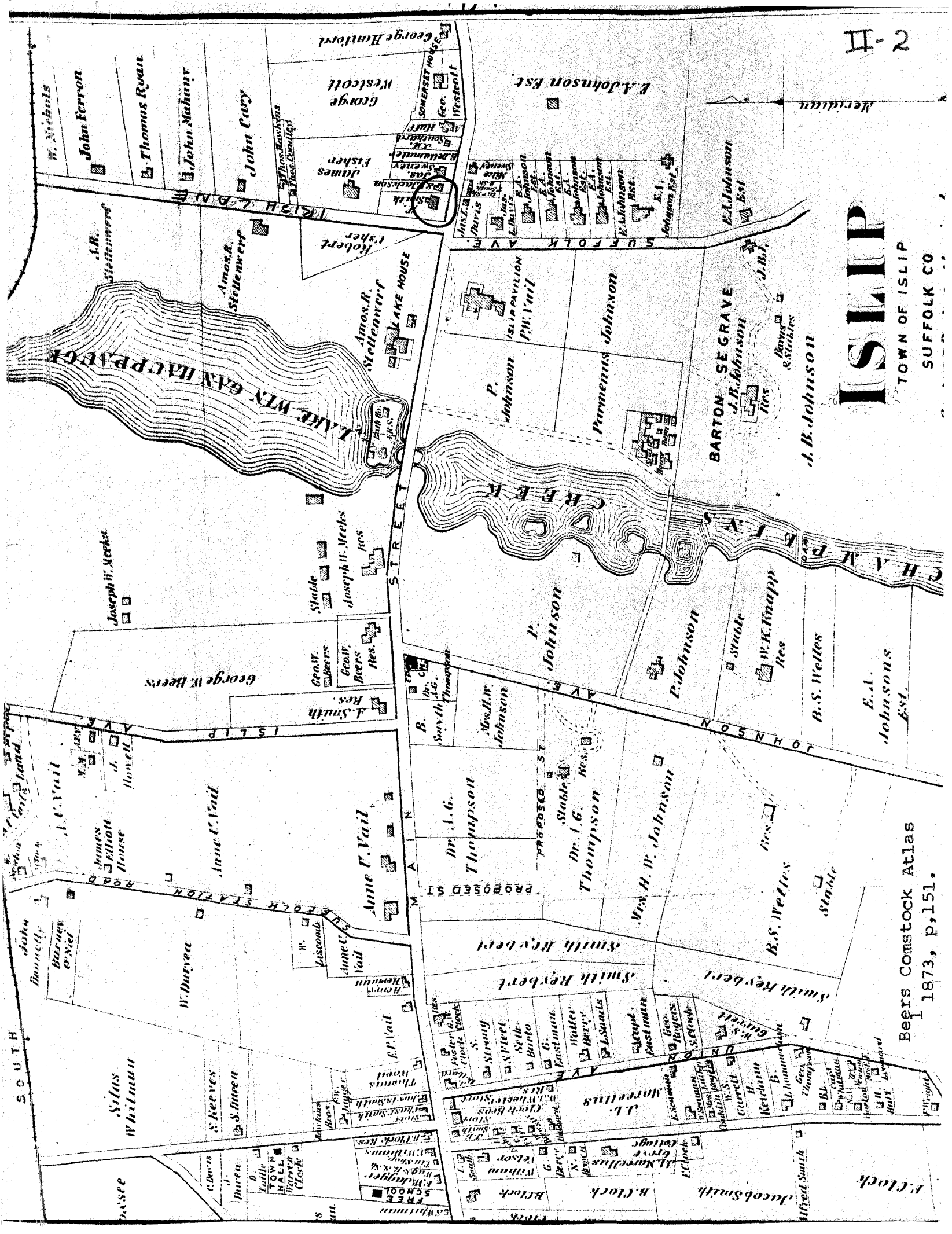

Beers Comstock Atlas
1873, p.151.