

372-01-061

II-9

BUILDING-STRUCTURE INVENTORY FORM

DIVISION FOR HISTORIC PRESERVATION
NEW YORK STATE PARKS AND RECREATION
ALBANY, NEW YORK (518) 474-0479

FOR OFFICE USE ONLY	
UNIQUE SITE NO.	_____
QUAD	_____
SERIES	_____
NEG. NO.	_____

YOUR NAME: Town of Islip DATE: 2 September 1976
Town Hall
 YOUR ADDRESS: 655 Main Street TELEPHONE: 516 581-2000
Islip, L.I., N.Y. 11751
 ORGANIZATION (if any): Department of Planning, Housing & Development

IDENTIFICATION

- BUILDING NAME(S): 83 Main Street, Northeast corner Third Street
- COUNTY: Suffolk TOWN/CITY: Islip VILLAGE: East Islip
- STREET LOCATION: 83 Main St., NE corner 3rd St. & Main St.
- OWNERSHIP: a. public b. private
- PRESENT OWNER: _____ ADDRESS: _____
- USE: Original: Residence Present: Residence
- ACCESSIBILITY TO PUBLIC: Exterior visible from public road: Yes No
Interior accessible: Explain _____

DESCRIPTION

- BUILDING MATERIAL: a. clapboard b. stone c. brick d. board and batten
e. cobblestone f. shingles g. stucco other: modern siding
- STRUCTURAL SYSTEM: a. wood frame with interlocking joints
(if known) b. wood frame with light members
c. masonry load bearing walls
d. metal (explain) _____
e. other _____
- CONDITION: a. excellent b. good c. fair d. deteriorated
- INTEGRITY: a. original site b. moved if so, when? _____
c. list major alterations and dates (if known):
modern siding, porches remodelled

ROLL ISL-BAN-II-9
NEGATIVE II-11

12. PHOTO: LOOKING NE

13. MAP:

SEWER MAP Q-11

Bowe, Albertson & Assoc. Sewer Map

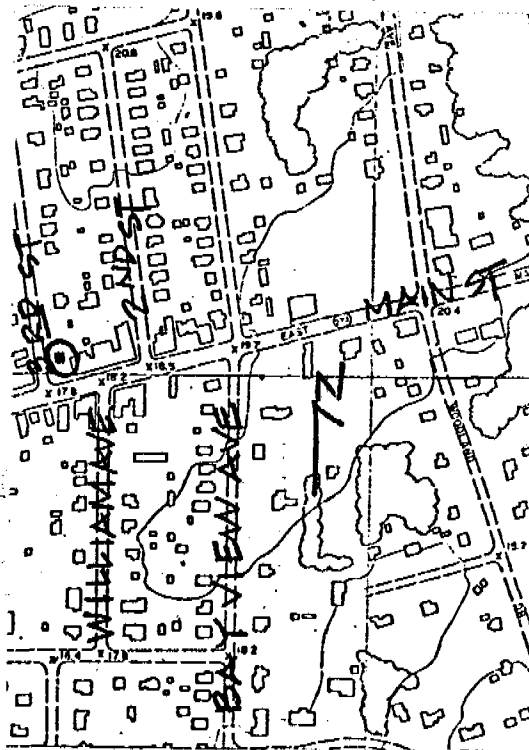

NEGATIVES DEPOSITED AT
SOCIETY FOR PRESERVATION OF
L. I. ANTIQUITIES

14. THREATS TO BUILDING: a. none known b. zoning c. roads
 d. developers e. deterioration
 f. other: _____

15. RELATED OUTBUILDINGS AND PROPERTY:
 a. barn b. carriage house c. garage
 d. privy e. shed f. greenhouse
 g. shop h. gardens
 i. landscape features: _____
 j. other: _____

16. SURROUNDINGS OF THE BUILDING (check more than one if necessary):
 a. open land b. woodland
 c. scattered buildings
 d. densely built-up e. commercial
 f. industrial g. residential
 h. other: _____

17. INTERRELATIONSHIP OF BUILDING AND SURROUNDINGS:
 (Indicate if building or structure is in an historic district)

18. OTHER NOTABLE FEATURES OF BUILDING AND SITE (including interior features if known):
 2 story 3 bay house; gable end to the street with 1 story wing on West side; 6/6 windows.

SIGNIFICANCE

19. DATE OF INITIAL CONSTRUCTION: Before 1873?

ARCHITECT: _____

BUILDER: _____

20. HISTORICAL AND ARCHITECTURAL IMPORTANCE:

1873 map: Hanford?
 1915 map: 2 story structure; owner not named.

21. SOURCES:

Beers, S. W. Atlas of Long Island, N.Y. N.Y.: Beers, Comstock & Cline, 1873.?
 Hyde, E. Belcher. Atlas of the Ocean Shore of Suffolk County, L.I.
 22. THEME: Westerly Section. Brooklyn-Manhattan, 1915.

Research by: Society for the Preservation of Long Island Antiquities
 Barbara Nadel, Research Assistant