

BUILDING-STRUCTURE INVENTORY FORM

DIVISION FOR HISTORIC PRESERVATION
NEW YORK STATE PARKS AND RECREATION
ALBANY, NEW YORK (518) 474-0479

FOR OFFICE USE ONLY	
UNIQUE SITE NO.	<u>103-05-0362-D24</u>
QUAD	_____
SERIES	_____
NEG. NO.	_____

Oa 6
green

YOUR NAME: Town of Islip Town Hall DATE: 5/21/79
655 Main Street
 YOUR ADDRESS: Islip, N.Y. TELEPHONE: (516) 224 5450
 ORGANIZATION (if any): Department of Planning and Development

IDENTIFICATION

1. BUILDING NAME(S): Vanderbilt Engineer's House
 2. COUNTY: Suffolk TOWN/CITY: Islip VILLAGE: Oakdale
 3. STREET LOCATION: 121 Central Blvd.
 4. OWNERSHIP: a. public b. private
 5. PRESENT OWNER: Vanni ADDRESS: see #3
 6. USE: Original: residence Present: residence
 7. ACCESSIBILITY TO PUBLIC: Exterior visible from public road: Yes No
 Interior accessible: Explain _____

DESCRIPTION

8. BUILDING MATERIAL: a. clapboard b. stone c. brick d. board and batten
 e. cobblestone f. shingles g. stucco other: _____
 9. STRUCTURAL SYSTEM: a. wood frame with interlocking joints
 (if known) b. wood frame with light members
 c. masonry load bearing walls
 d. metal (explain) _____
 e. other _____
 10. CONDITION: a. excellent b. good c. fair d. deteriorated
 11. INTEGRITY: a. original site b. moved if so, when? _____
 c. list major alterations and dates (if known): _____

12. PHOTO: Neg. 7, west facade
NJM-1

13. MAP: Bowe-Anderson
Composite

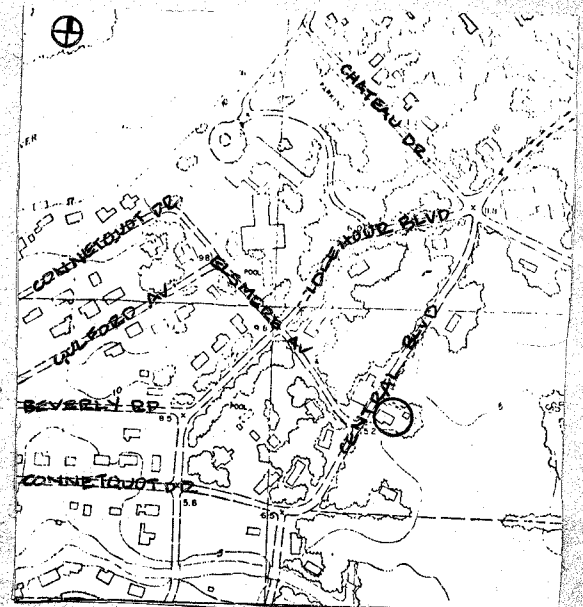

14. THREATS TO BUILDING: a. none known b. zoning c. roads
 d. developers e. deterioration
 f. other: _____
15. RELATED OUTBUILDINGS AND PROPERTY:
 a. barn b. carriage house c. garage
 d. privy e. shed f. greenhouse
 g. shop h. gardens
 i. landscape features: _____
 j. other: _____
16. SURROUNDINGS OF THE BUILDING (check more than one if necessary):
 a. open land b. woodland
 c. scattered buildings
 d. densely built-up e. commercial
 f. industrial g. residential
 h. other: _____

17. INTERRELATIONSHIP OF BUILDING AND SURROUNDINGS:
 (Indicate if building or structure is in an historic district)

As part of the William K. Vanderbilt estate, the Engineer's House is across the street from the Powerhouse.

18. OTHER NOTABLE FEATURES OF BUILDING AND SITE (including interior features if known):
 A relatively small, 2-story English-style house. The first floor is of smooth brick, while the second floor is half-timber and stucco. The hip roof has a wide overhang and extended rafter ends. The wall-faced dormers have hip roofs.

SIGNIFICANCE

19. DATE OF INITIAL CONSTRUCTION: 1904

ARCHITECT: _____

BUILDER: _____

20. HISTORICAL AND ARCHITECTURAL IMPORTANCE:

This building serves as an example of 19th century English style architecture, as part of the William K. Vanderbilt estate.

21. SOURCES: Merritt B. Hyde, Atlas of a Part of Suffolk County, Long Island, N.Y., South Shore, Ocean Side., E. Belcher Hyde, Brooklyn, N.Y., 1915, Vol. 1
 W. K. Vanderbilt Historical Society

22. THEME:

Prepared by: Society for the Preservation of Long Island Antiquities
 Setauket, New York 11733
 Nina Monastero, Research Assistant
 May, 1979