

BUILDING-STRUCTURE INVENTORY FORM

DIVISION FOR HISTORIC PRESERVATION
NEW YORK STATE PARKS AND RECREATION
ALBANY, NEW YORK (518) 474-0479

FOR OFFICE USE ONLY	
UNIQUE SITE NO. <u>105-05-0297</u>	DZ1
QUAD _____	
SERIES _____	
NEG. NO. _____	

Oa 17a
green

YOUR NAME: Town of Islip DATE: 5/22/79
655 Main Street
 YOUR ADDRESS: Islip, N.Y. TELEPHONE: (516) 224-5450
 ORGANIZATION (if any): Department of Planning and Development

IDENTIFICATION

1. BUILDING NAME(S): Vanderbilt ^{Estate: Water Tower} Clock Tower (The Artist Colony)
 2. COUNTY: Suffolk TOWN/CITY: Islip VILLAGE: Oakdale
 3. STREET LOCATION: Hollywood Avenue, South Side, at Tower Mews
 4. OWNERSHIP: a. public b. private
 5. PRESENT OWNER: Florence Bezruczyk ADDRESS: see #3
 6. USE: Original: water tower Present: residence
 7. ACCESSIBILITY TO PUBLIC: Exterior visible from public road: Yes No
 Interior accessible: Explain _____

DESCRIPTION

8. BUILDING MATERIAL: a. clapboard b. stone c. brick d. board and batten
 e. cobblestone f. shingles g. stucco other: _____
 9. STRUCTURAL SYSTEM: (if known) a. wood frame with interlocking joints
 b. wood frame with light members
 c. masonry load bearing walls
 d. metal (explain) _____
 e. other _____
 10. CONDITION: a. excellent b. good c. fair d. deteriorated
 11. INTEGRITY: a. original site b. moved if so, when? _____
 c. list major alterations and dates (if known):
barn burned, partially rebuilt. Brick tower remains preserved.

12. PHOTO: ELW IX, #6, from NE

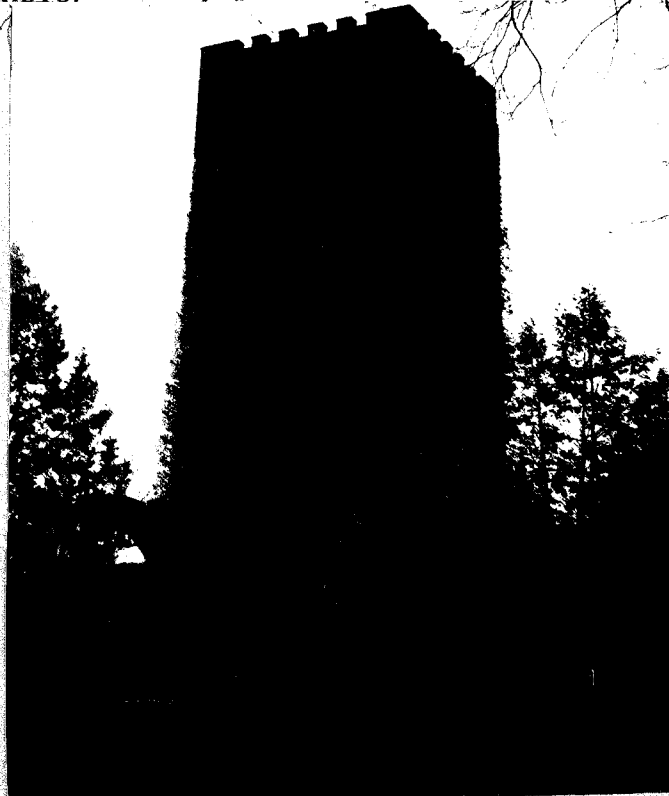

13. MAP: Bowe-Anderson Composite

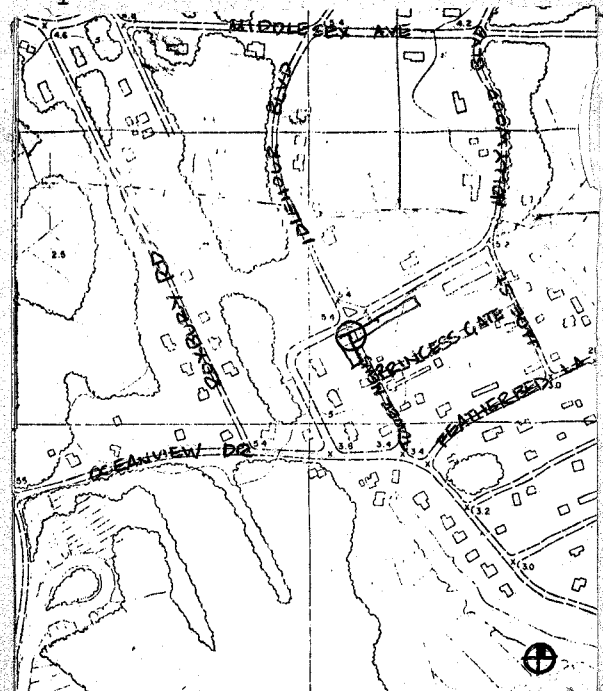

14. THREATS TO BUILDING: a. none known b. zoning c. roads
 d. developers e. deterioration
 f. other: _____
15. RELATED OUTBUILDINGS AND PROPERTY:
 a. barn b. carriage house c. garage
 d. privy e. shed f. greenhouse
 g. shop h. gardens
 i. landscape features: _____
 j. other: adjacent brick cottage
16. SURROUNDINGS OF THE BUILDING (check more than one if necessary):
 a. open land b. woodland
 c. scattered buildings
 d. densely built-up e. commercial
 f. industrial g. residential
 h. other: _____

17. INTERRELATIONSHIP OF BUILDING AND SURROUNDINGS:

(Indicate if building or structure is in an historic district)

The clock tower is part of the west barn in the historic Artist Colony sector of the Vanderbilt Estate. The Clock Tower itself is situated at the southern end of Idlehour Blvd.

18. OTHER NOTABLE FEATURES OF BUILDING AND SITE (including interior features if known):

9 story brick structure, divided into 4 levels with brick buttresses and battlement-like parapet.

SIGNIFICANCE19. DATE OF INITIAL CONSTRUCTION: 1890ARCHITECT: R. H. HuntBUILDER: William Bason and Sons

20. HISTORICAL AND ARCHITECTURAL IMPORTANCE:

This building is part of the farm area of the Vanderbilt estate. In 1926, this area was purchased by Lucy Sawyer Pritchard Thompson and her son, William, turned it into The Artist Colony, a haven for many New York City Artists.

collections W.K.Vanderbilt Historical Society
 21. SOURCES: "Idle Hour Residents Waltz to Reprise of Artist's Life", Linda Williams, Newsday October 9, 1969.

Liza Hammel, "Home, Sweet Tower," N.Y. Times, March 16, 1968.

22. THEME:

Prepared by: Society for the Preservation of Long Island Antiquities
 Setauket, New York 11733
 Nina Monastero, Research Assistant
 May, 1979

IDLE HOUR
Wm. K. Vanderbilt West Barn
Artist's Colony



Remains of
West Barn

ELW IX-5 Looking south thru the west arches of West Barn today



ELW X-2 Remains of West Barn from NE. Clock tower was restored as
a residence after the fire.

William K. Vanderbilt West Barn, Built 1900, at west end, cows were kept.
Farm horses were kept at east end of building.

Idle Hour West barn and clock tower
From: Collection of W.K. Vanderbilt Historical Society

