

BUILDING-STRUCTURE INVENTORY FORM

DIVISION FOR HISTORIC PRESERVATION
NEW YORK STATE PARKS AND RECREATION
ALBANY, NEW YORK (518) 474-0479

FOR OFFICE USE ONLY

UNIQUE SITE NO. 103-05-036-022
QUAD _____
SERIES _____
NEG. NO. _____

Oa 54

green

YOUR NAME: Town of Islip Town Hall DATE: 6/18/79

YOUR ADDRESS: 655 Main Street
Islip, N.Y. TELEPHONE: (516)224-5450

ORGANIZATION (if any): Department of Planning and Development

IDENTIFICATION

- 1. BUILDING NAME(S): Bourne Estate Pumping Station and Shop
- 2. COUNTY: Suffolk TOWN/CITY: Islip VILLAGE: Oakdale
- 3. STREET LOCATION: Montauk Hwy; South Side
- 4. OWNERSHIP: a. public b. private
- 5. PRESENT OWNER: W.O.R.C. ADDRESS: Oakdale, New York
- 6. USE: Original: Coach House Present: Recreation Hall
- 7. ACCESSIBILITY TO PUBLIC: Exterior visible from public road: Yes No
Interior accessible: Explain _____

DESCRIPTION

- 8. BUILDING MATERIAL: a. clapboard b. stone c. brick d. board and batten
e. cobblestone f. shingles g. stucco other: _____
- 9. STRUCTURAL SYSTEM: (if known) a. wood frame with interlocking joints
b. wood frame with light members
c. masonry load bearing walls
d. metal (explain) _____
e. other _____
- 10. CONDITION: a. excellent b. good c. fair d. deteriorated
- 11. INTEGRITY: a. original site b. moved if so, when? _____
c. list major alterations and dates (if known):
Aluminum siding under eaves

12. PHOTO: neg 21a, NJM-2

13. MAP: Bowe-Anderson Q-14



from southwest

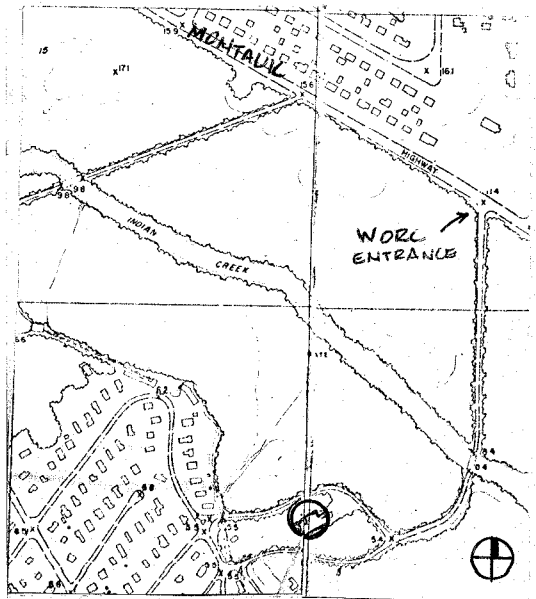

14. THREATS TO BUILDING: a. none known b. zoning c. roads
 d. developers e. deterioration
 f. other: _____
15. RELATED OUTBUILDINGS AND PROPERTY:
 a. barn b. carriage house c. garage
 d. privy e. shed f. greenhouse
 g. shop h. gardens
 i. landscape features: _____
 j. other: _____
16. SURROUNDINGS OF THE BUILDING (check more than one if necessary):
 a. open land b. woodland
 c. scattered buildings
 d. densely built-up e. commercial
 f. industrial g. residential
 h. other: _____
17. INTERRELATIONSHIP OF BUILDING AND SURROUNDINGS:
 (Indicate if building or structure is in an historic district)

The former Pump House was once part of the Frederick G. Bourne estate. It is located on a peninsula of land bound by the entrance and exit roads to the recreation camp, south of Montauk Highway.

18. OTHER NOTABLE FEATURES OF BUILDING AND SITE (including interior features if known):
 8 bay, long, low, symmetrical, 1 story stucco structure, with slightly bell cast hip roof that has ventilator. Two sliding doors.

SIGNIFICANCE

19. DATE OF INITIAL CONSTRUCTION: 1913

ARCHITECT: I.H. Green Jr. of Sayville*

BUILDER: Wm. Bason of Sayville, subcontractor to Jacobs & Young

20. HISTORICAL AND ARCHITECTURAL IMPORTANCE:

See Oa 45, # 4.

The Pumping Station was originally the source of water and power for the buildings of the Bourne Estate, primarily the Mansion, Indian Neck Hall, and was designed by a prominent local architect.

21. SOURCES:

See Oa 45, #6

Also,

*I.H. Green, Blueprints of Pumping Station and Shop, 1913.

22. THEME:

Prepared by: Society for the Preservation of Long Island Antiquities
 Setauket, New York 11733
 Nina Monastero, Research Assistant
 June, 1979

LA SALLE MILITARY ACADEMY

Oa 54

OAKDALE, NEW YORK 11769

(516) 589-0900

BOURNE BLUEPRINT COLLECTION

BOX I (cont'd.)

D. Plans for Shop and Pumping Station at Oakdale, N.Y. for Comm. F.G. Bourne.

Architect: I.H. Green
Sayville, N.Y.

The following drawing are bound. The dates for each are listed and these are found on the individual drawings. Drawing #7 is missing and appears to have been torn out.

- Sheet: #1 - Foundation Plan, December 2, 1913
#2 - Floor Plan, December 3, 1913
#3 - South Elevation, December 1, 1913
#4 - North Elevation, December 1, 1913
#5 - East Elevation, December 2, 1913
#6 - Longitudinal Section, December 3, 1913
#8 - Detailed Elevation of Truss B,C & D, November 20, 1913
#9 - $\frac{1}{2}$ Detailed Elevation of Truss A, December 4, 1913

E. Flagpole on Boathouse

Architect, date drawing number undeterminable.

F. Floodgates

Architect, date, drawing number undeterminable.