

# BUILDING-STRUCTURE INVENTORY FORM

DIVISION FOR HISTORIC PRESERVATION  
NEW YORK STATE PARKS AND RECREATION  
ALBANY, NEW YORK (518) 474-0479

FOR OFFICE USE ONLY	
UNIQUE SITE NO.	<u>103-05-0308</u>
QUAD	_____
SERIES	_____
NEG. NO.	_____

DZ1

YOUR NAME: Town of Islip Town Hall DATE: 5/22/79  
 YOUR ADDRESS: 655 Main Street TELEPHONE: (516) 224-5450  
Islip, N.Y.  
 ORGANIZATION (if any): Department of Planning and Development

\*\*\*\*\*

### IDENTIFICATION

- BUILDING NAME(S): ~~61 Princess Gate~~ (The Artist Colony)
- COUNTY: Suffolk TOWN/CITY: Islip VILLAGE: Oakdale
- STREET LOCATION: 61 Princess Gate
- OWNERSHIP: a. public  b. private
- PRESENT OWNER: \_\_\_\_\_ ADDRESS: \_\_\_\_\_
- USE: Original: \_\_\_\_\_ Present: residence
- ACCESSIBILITY TO PUBLIC: Exterior visible from public road: Yes  No   
Interior accessible: Explain \_\_\_\_\_

### DESCRIPTION

- BUILDING MATERIAL: a. clapboard  b. stone  c. brick  d. board and batten   
e. cobblestone  f. shingles  g. stucco  other: \_\_\_\_\_
- STRUCTURAL SYSTEM: a. wood frame with interlocking joints   
(if known) b. wood frame with light members.   
c. masonry load bearing walls   
d. metal (explain) \_\_\_\_\_  
e. other \_\_\_\_\_
- CONDITION: a. excellent  b. good  c. fair  d. deteriorated
- INTEGRITY: a. original site  b. moved  if so, when? \_\_\_\_\_  
c. list major alterations and dates (if known): \_\_\_\_\_

12. PHOTO: Neg. 28, south facade  
NJM-1

13. MAP: Bowe-Anderson  
Composite A

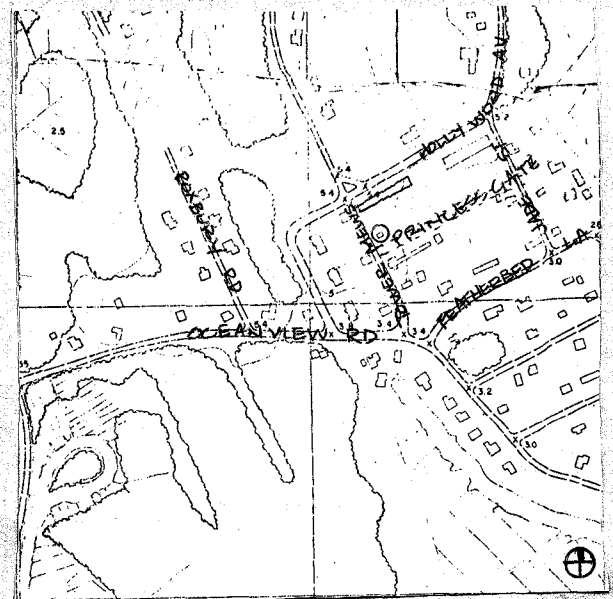

14. THREATS TO BUILDING: a. none known  b. zoning  c. roads   
 d. developers  e. deterioration   
 f. other: \_\_\_\_\_

15. RELATED OUTBUILDINGS AND PROPERTY:  
 a. barn  b. carriage house  c. garage   
 d. privy  e. shed  f. greenhouse   
 g. shop  h. gardens   
 i. landscape features: \_\_\_\_\_  
 j. other: \_\_\_\_\_

16. SURROUNDINGS OF THE BUILDING (check more than one if necessary):  
 a. open land  b. woodland   
 c. scattered buildings   
 d. densely built-up  e. commercial   
 f. industrial  g. residential   
 h. other: Similar buildings of farm complex

17. INTERRELATIONSHIP OF BUILDING AND SURROUNDINGS:  
 (Indicate if building or structure is in an historic district)  
 At Tower Mews Road, opposite south end of L of West Barn,  
 in the historic Artist Colony.

18. OTHER NOTABLE FEATURES OF BUILDING AND SITE (including interior features if known):  
 1 story brick structure with segmental arches at window and  
 door openings. Original vent survives on roof.

**SIGNIFICANCE**

19. DATE OF INITIAL CONSTRUCTION: 1890

ARCHITECT: \_\_\_\_\_

BUILDER: William Bason and Sons

20. HISTORICAL AND ARCHITECTURAL IMPORTANCE:  
 This building was part of the farm area of the Vanderbilt  
 Estate. In 1926, this area was purchased by Lucy Sawyer  
 Pritchard Thompson and her son, William, turning it into  
 the Artist Colony, a haven for many New York City artists.

21. SOURCES:  
 Charles P. Dickerson, A History of the Sayville Community,  
 Suffolk County News, 1975.

22. THEME:  
 Prepared by: Society for the Preservation of Long Island  
 Antiquities  
 Setauket, New York 11733  
 Nina Monastero, Research Assistant  
 May, 1979